

Marine loading arm – B0030

The B0030 Marine Loading Arm is preferred when loading/unloading sea-going tankers and it proved its reliability within many years of trouble free operation worldwide.

The B0030 with its self-supporting design includes a rigid link pantograph system with independent counterweights balancing the inboard- and outboard arm. This provides accurate balance throughout the entire operational range. The B0030 Marine Loading Arm is synonymous for high safety standards and especially the self-supporting design means lowest possible dock loads, which minimizes cost for the dock itself.

The advantages in comparison with hose loading facilities are ease of handling, higher availability/flexibility, less manpower and minimum maintenance, resulting in maximum operational safety and minimum cost of ownership.

The B0030 Marine Loading Arm can be manually or hydraulically operated.

Additional equipment is available.

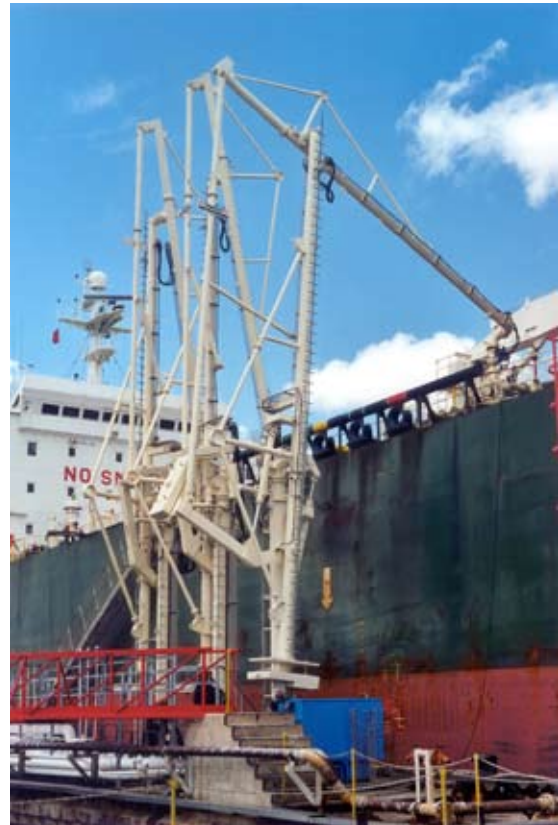

- sizes from 4" up to 20"
- for 150 lbs or 300 lbs pressure ratings
- materials: carbon steel, low temperature steel, stainless steel
- temperature range: -55 °F up to +390 °F
- manually or hydraulically operated
- with various accessories
- for special applications we offer engineered solutions

B0030

Dimensions and technical data

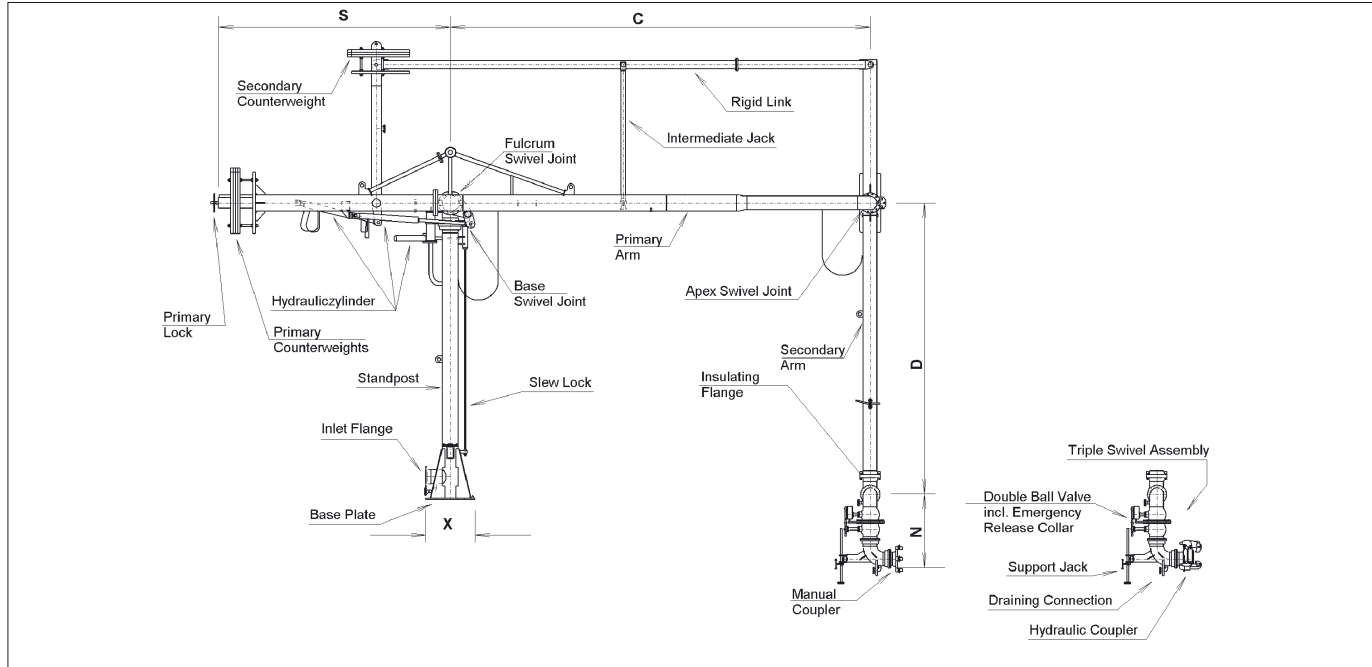

Technical data (standard) – excl. emergency release system

NB	A + B ft	X ft	C ft	D ft	N ft	S ft	flow rate gal/min	weight lbs	bending moment Lb ft
4"	15	4	26	26	2	12	1,320	13,900	77,000
6"	15	4	26	26	2	12	2,640	14,200	78,500
8"	15	4	29.5	29.5	2.4	12	4,850	19,500	108,000
10"	20	6	33	33	3	17	7,500	26,700	172,000
12"	23	6	36	36	3.4	20	11,000	35,200	254,500
16"	23	6	36	36	4.3	20	17,500	50,000	375,000
20"	Details available on request								

Design

- fully balanced with independent counterweights for inboard and outboard arm
- self supporting system
- less man power due to low weight
- swivel joints either welded-in or flanged
- for transfer of mineral oil, chemicals and liquefied gases
- seals available in Buna-N, Viton, PTFE or other specific materials

Accessories

- range alarm system
- drainage connections
- emergency release system (ERS)
- manual or hydraulic operation
- manual or hydraulic quick coupler
- insulation flange
- nitrogen purge line
- vacuum breaker
- vapour return line



EMCO WHEATON

A Gardner Denver Product

Whilst the content of this leaflet has been edited with the greatest care, we are not liable for any errors and/or omissions. Subject to change without notice.

EMCO WHEATON USA INC
 9111 Jackrabbit Road · Houston, Texas 77095 · USA
 Phone +1 281 856-1300 · Fax +1 281 856-1325
 www.emcowheaton.com · sales-us@emcowheaton.com