

OPW 61fSTOP "THE STOPPER" OVERFILL PREVENTION VALVES

The OPW 61fSTOP Overfill Prevention Valve ("The Stopper") is designed to prevent overfilling of aboveground storage tanks by providing a positive shut-off during a pressurized-fill (pump-on fill) delivery. "The Stopper" threads into the fill opening and is an integral part of the fill tube. The OPW61fSTOP is fully adjustable to allow for easy installation in new or existing aboveground tanks of various heights and storage capacities.

The Stopper is a single-action, complete shut-off valve. When the liquid level rises to your specific, pre-determined tank capacity, the valve mechanism is released and automatically closes with the flow of the product. Any excess product left between the valve and the fuel delivery coupler is drained into the tank through internal drain vents. The drain vents on the 61fSTOP act as an anti-siphon, by introducing air/vapor into the fill line, to help isolate the tank from a potential siphon due to a broken or leaking fill pipe.

The 61fSTOP, available in either 2" or 3" full-flow models, maximizes flow rates and minimizes delivery times. The 2" 61fSTOP requires a 4" tank opening and minimum tank ullage (space from the top of the stored product to the inside top of the tank) of 8" on the 61fSTOP-1000 Cylindrical Float model and a minimum ullage of 4" on the 61fSTOP-2000 Float Arm model. The 61fSTOP-1000, with the cylindrical float, eliminates the need to position the valve to avoid tank walls or cross-bracing. The 61fSTOP-2000 with the float arm allows for increased usable storage capacity in the tank, and is well-suited for small capacity rectangular ASTs. The 3" 61fSTOP requires a 6" tank opening and incorporates a cylindrical float requiring 8" of tank ullage space. The 3" Stopper is a high-flow unit that can accommodate flow rates over 400 gallons per minute (depending on pump capacity).

The 61fSTOP-100M and -200M are anodized and compatible with 100% methanol or ethanol fuels. The OPW 61fSTOP-305A meets with the specifications of the Handbook of Aviation Fuels Properties for Aviation/Jet Fuel Compatibility (as developed by the Coordinating Research Council of the Society of Automotive Engineers). The 61fSTOP-305A is compatible with aviation fuels (including jet fuels), gasoline, gasoline-alcohol fuels, diesel, kerosene, mogas, fuel oil, motor oils (up to 60W) and anti-freeze.

ONE COMPANY. ONE WORLD. ONE SOURCE.™

Materials

Valve body, adaptor and collar: cast aluminum

Poppet: cast aluminum, hard-coated

Cam: stainless steel

Follower: brass

Shaft: CRS zinc-plated

Bearing: sintered bronze

Float: closed-cell nitrile

Nipple: 2" - 3" schedule 40 steel pipe

Lower nipple: 2" - 3" schedule 40 steel pipe with Duragard® coating



Features

- ◆ **Simple, Easy and Quick Installation** – The valve is adjusted to the proper shut-off level and threaded into the top of the tank.
 - and piped to a remote location where the couplers are contained in a 211-RMOT Spill Container.
- ◆ **Furnished Complete** – A special crossbar tank-inlet adaptor is provided with each Stopper to provide for tight-fills and help prohibit open-fills. Mounting hardware, upper drop tube and 14" lower drop tube provided (longer-length drop tubes can be purchased or added).
- ◆ **Completely Automatic Operation** – No pre-checks to perform, no resets, and no overrides to be broken or abused.
- ◆ **Direct or Remote-Fill Compatible** – Fuel delivery couplers can be connected directly to the 61fSTOP, or steel pipe can be threaded into the top of the valve
- ◆ **Integral Anti-Siphon Valve** – Drain vents on the 61fSTOP act as an anti-siphon, by introducing air/vapor into the fill line after the valve actuates, to help isolate the tank from a potential siphon due to a broken or leaking remote-fill pipe.
- ◆ **150 psi (10 bar) Pressure Rated* with Low Pressure Drop** – To enable quick, safe delivery of fuel into the tank.
- ◆ **25 GPM (95 lpm) Minimum Flow Rate Required.**
- ◆ **UL and ULC Listed** – To satisfy Third Party accreditation requirements of many jurisdictions.
- ◆ **CARB Approved AST 01-01.**

*OPW does not recommend pumping pressures above 100 psi for Class 1B fuels or remote applications and we make no warranties for products use in conjunction with the 61fSTOP.

NOTE: OPW recommends the use of the 61fSTOP with clean product only. Debris and other products such as contaminated waste oil may cause improper operation of the valve.

NOTE: The 61fStop can be used in gravity drop provided the minimum flow rate is maintained. A tight shut off is not achieved in the closed position. However with a minimum tank size of 1,000 gallons, the leak rate will provide a 30 minute warning before the tank is full.

Listings and Certifications



For more information contact
OPW Customer Service at
1-800-422-2525; International call
1-513-870-3315.

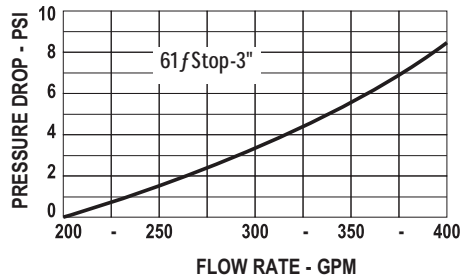
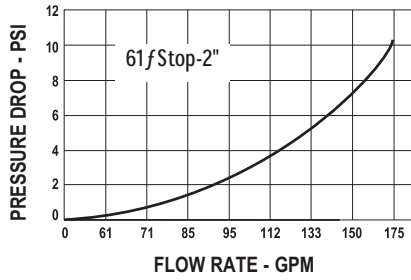

Ordering Specifications and Dimensions

Product #	Description	A		B		C		D		E		F	
		in.	cm	in.	cm	in.	cm	in.	cm	in.	cm	in.	cm
61fSTOP-1000	2" Cyl. Float	3	7.6	10	25.4	2	5.1	9	22.4	3 ¹ / ₁₆	10	n/a	n/a
61fSTOP-100M*	2" Cyl. Float for Methanol	3	7.6	10	25.4	2	5.1	9	22.4	3 ¹ / ₁₆	10	n/a	n/a
61fSTOP-2000	2" Float Arm	3	7.6	10	25.4	1/2	3.8	5-18	22.4	1 ³ / ₁₆	5	6	15.2
61fSTOP-200M*	2" Float Arm for Methanol	3	7.6	10	25.4	1/2	3.8	5-18	22.4	1 ³ / ₁₆	5	6	15.2
61fSTOP-3050	3" Cyl. Float	3	7.6	10 ³ / ₈	27	2	5.1	8	20.3	5 ¹ / ₈	13	n/a	n/a
61fSTOP-305A*	3" Cyl. Float for Aviation or Methanol	3	7.6	10 ³ / ₈	27	2	5.1	8	20.3	5 ¹ / ₈	13	n/a	n/a

*Recommended for E85

Replacement Parts 2"

Product #	Description
C04093M	4" Retaining Collar
C04114RS	14" Nipple
H12617M	Float for 1000 (4 pieces required)
61ARM-2000	Floating Arm Retrofit Kit For 2000

Replacement Parts 3"

Product #	Description
D02037M	6" Retaining Collar
C04474RS	14" Nipple
C04438M	Float (4 pieces required for 3050)

Ordering Specifications and Dimensions

Product #	Description
61FT-0206	2" x 6' Drop Tube Kit
61FT-0312	3" x 12' Drop Tube Kit

61FSTOP-1000, 100M, 200M Instruction Sheet Order Number: **H12676M**

61FSTOP-2000 Instruction Sheet Order Number: **H13337M**

61FSTOP-3000, 3050, 305A Instruction Sheet Order Number: **H13315M**

61FT-0312, 0206 Instruction Sheet Order Number: **H14428PA**

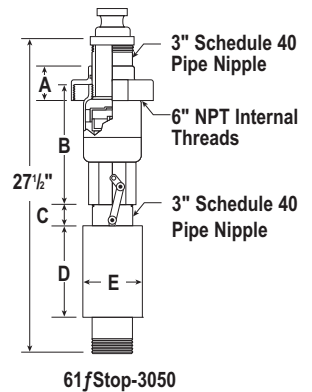
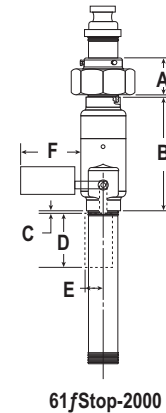
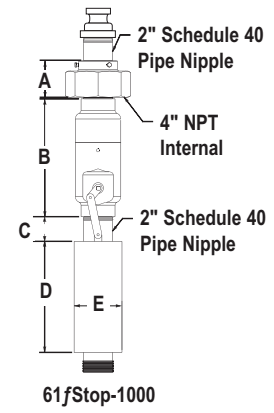

OPW 61FT DROP TUBE

The OPW 61FT Drop Tube is designed to install on the bottom of the 61fSTOP AST Overfill Prevention Valves when a lightweight, longer, lower drop tube is required. Constructed of extruded aluminum, the OPW 61FT is connected to the bottom of the 61fSTOP by a clevis and cotter pin assembly, and allows for submerged filling of ASTs.

Important

FlexWorks by OPW, Inc., VAPORSAVER™ and all other OPW products must be used in compliance with all applicable federal, state, provincial and local laws, rules and regulations. Product selection must be based on physical specifications and limitations, compatibility with the environment and material to be handled. All illustrations and specifications in this literature are based on the latest production information available at the time of publication. Prices, materials and specifications are subject to change at any time, and models may be discontinued at any time, in either case, without notice or obligation. OPW warrants solely to its customer that the following products sold by OPW will be free from defects in materials and workmanship under normal use and conditions for the periods indicated.